

CORNER RESTORATION

CORNER: S1/4 SEC. 11, TWP. 13 S., RANGE 33 E., W.M.

ORIGINAL SURVEY BY: John B. David

CONTRACT NUMBER: 131

CONTRACT DATE: June 8, 1869

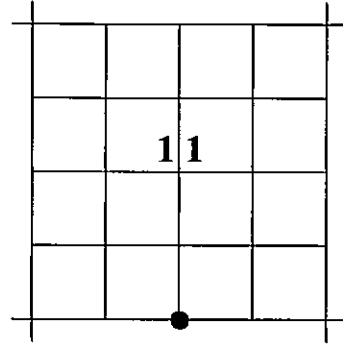

SUBSEQUENT SURVEYS:

- ▶ By Robert Bagett, County Surveyor in 1976
- ▶ By Robert Bagett, County Surveyor in 2003.

ORIGINAL DESCRIPTION: set stone 14"x9"x6" for 1/4 Sec. corner.

- ▶ 1976: Corner was remonumented by Bagett with a County Surveyor brass cap. The position was determined from Prairie City Land Company's First Addition - See Record Survey No. 422.
- ▶ 2003: Corner was recovered by Bagett. He set new reference points for the existing monument (See 2003 Corner Restoration Sheet for details on accessories).

EVIDENCE FOUND AND NEW ACCESSORIES: Found a 1½" iron pipe with attached 2½" Grant County Surveyor brass cap, marked as shown below. We found the reference points set by Bagett in 2003 all in good condition.

AT THE CORNER POINT: We built a 2 ft. mound of stone surrounding the found monument.

STATE PLANE COORDINATES (3601 OR N)

Reference Datum: NAD83 From OPUS solution

Northing: 289,473.2 ft.

Easting: 8,670,522.9 ft.

Ellip. Ht: 3,587.4 ft.

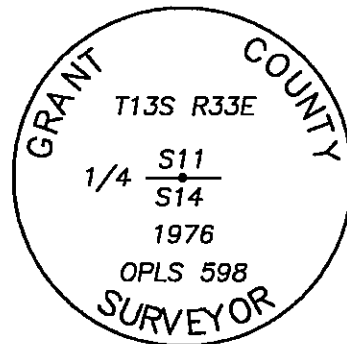

RESTORATION BY, STAMP AND DATE:

Michael C. Springer, Grant County Surveyor

Jason L. Hatfield, Deputy County Surveyor

Surveyed December 16, 2011

RECEIVED AND FILED
GRANT COUNTY SURVEYOR

JAN 27 2012

BY: 

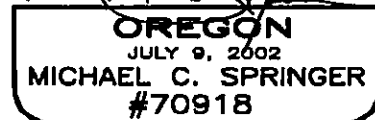

EXPIRES: 6/30/2012